

Cross Sections

Legend

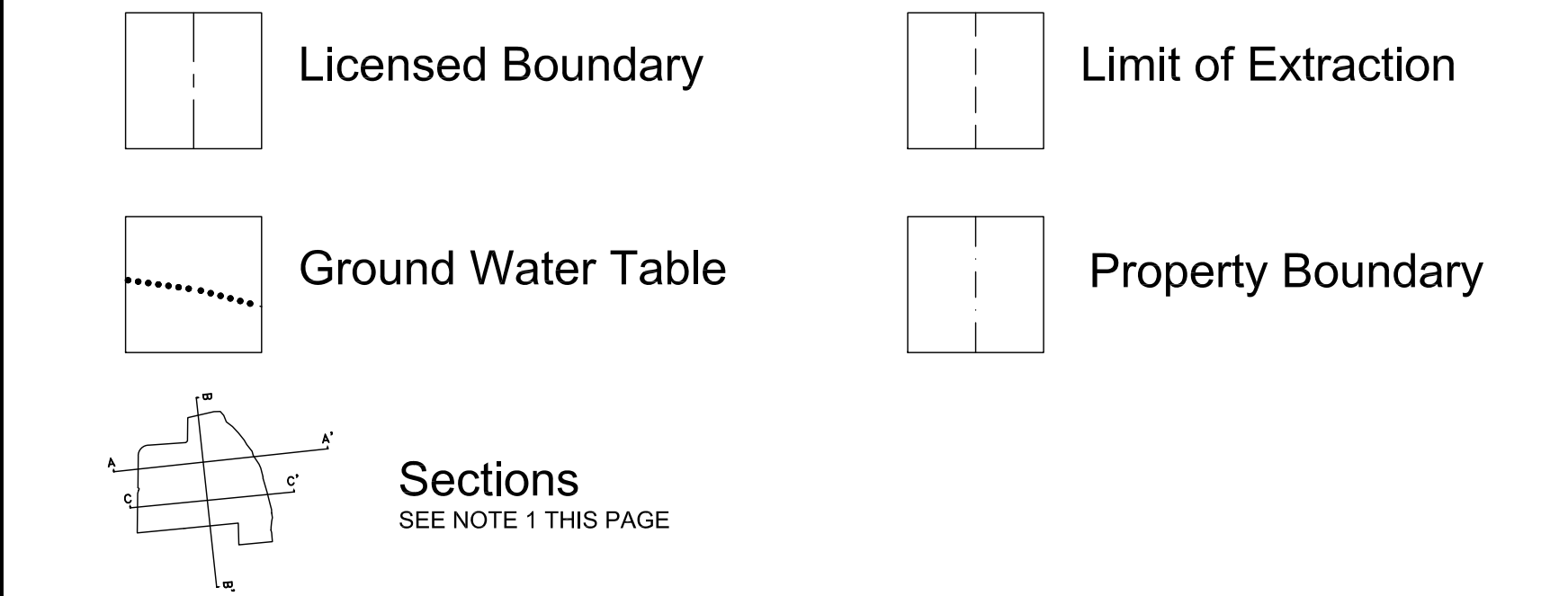

Notes

- FOR PLAN VIEW OF CROSS SECTIONS SEE PAGE 2 OF 5 'EXISTING FEATURES' AND PAGE 4 OF 5 'PROGRESSIVE REHABILITATION AND FINAL REHABILITATION PLAN'.
- CROSS SECTIONS PLOTTED FROM CONTOUR INFORMATION PROVIDED BY MCELHANNY GEOSURVEYS LTD. DEC. 1990
- GROUND WATER TABLE IDENTIFIED BY WATERLOO GEOSCIENCE CONSULTANTS LTD.

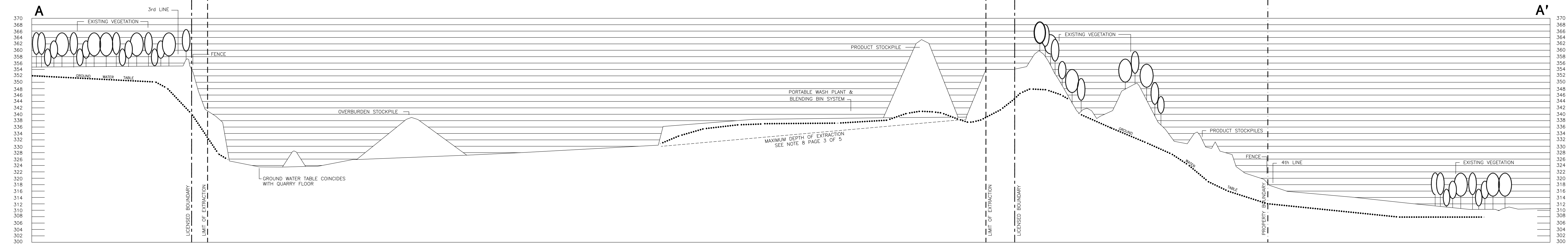

Section A-A' Existing Condition

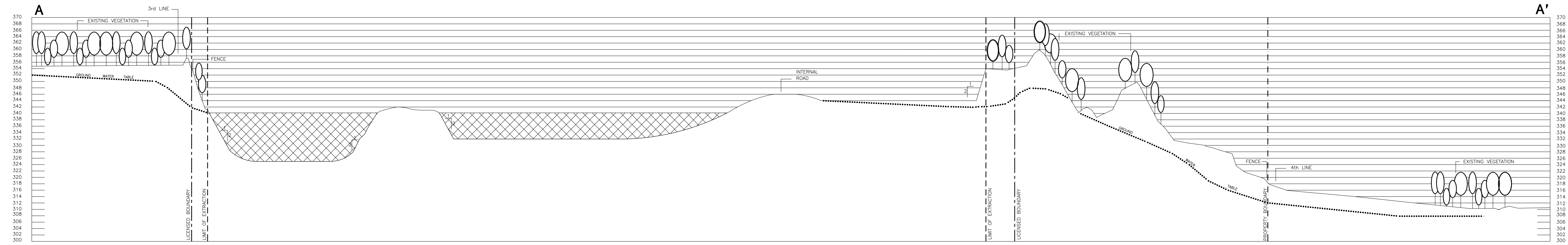

Section A-A' Rehabilitated Condition

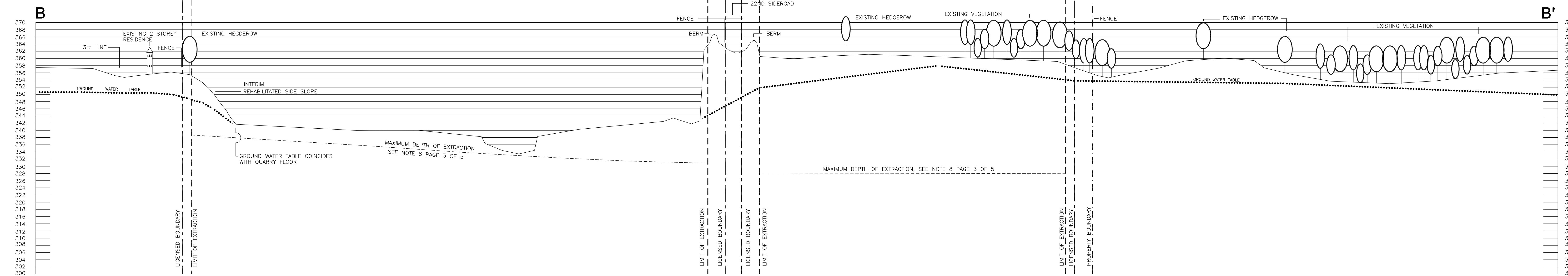

Section B-B' Existing Condition

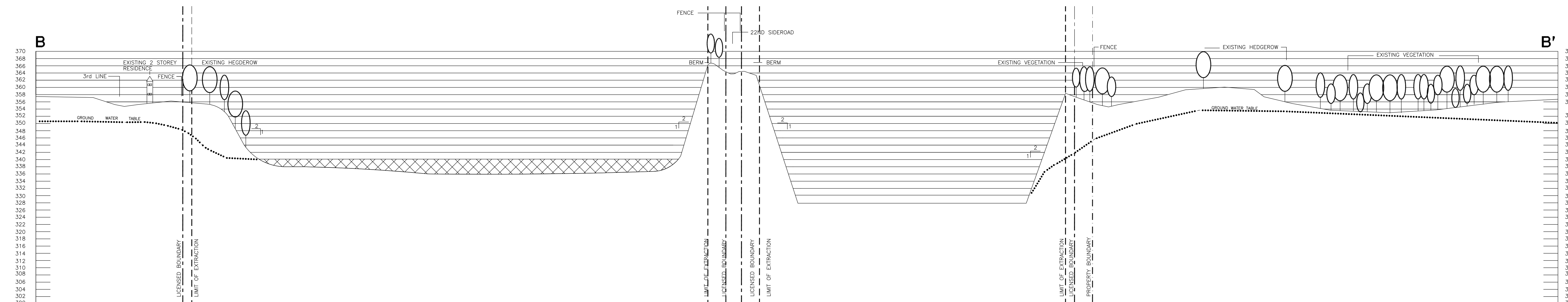

Section B-B' Rehabilitated Condition

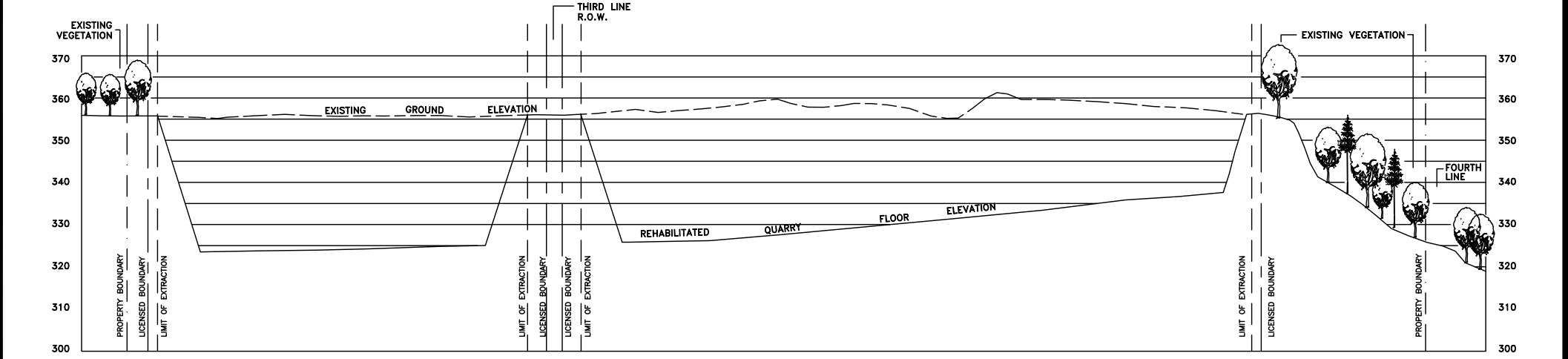

Section C-C' Existing and Rehabilitated Conditions

Scale: Hor. 1:4000
Vert. 1:500

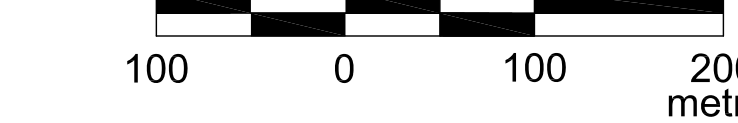

IAN F. MACQUIGTON, BERNARD P. HERRON AND JAMES D. FARRON ARE AUTHORIZED BY THE MINISTRY OF NATURAL RESOURCES PURSUANT TO SEC. 6(4) OF THE AGGREGATE RESOURCES ACT TO PREPARE AND CERTIFY SITE PLANS.

Submitted in accordance with the Aggregate Resources Act section 69 dated MARCH 26, 1991.
 Approved by the Ministry of Natural Resources dated DEC. 02, 1993.
 AMENDMENTS
USE TO SHOW OTHER CROSS SECTIONS & PLAN VIEWS
 SEE NOTE 1 - ASSESS CROSS SECTIONS TO REFLECT RECENT CHANGES.

 13 Poyntz Street Barrie, Ontario, L4M 3N6
 Telephone (705) 728-0045 Fax (705) 728-2010
 www.mhbcplan.com

PROJECT NAME:
Acton Quarry

Job No. 9061AU UNIT HALT HALT
 Dwn. By: A.S. Chkd. By: BZ
 N:\Briem\9061AU Acton Quarry Rehab\Drawings\ARA
 Site Plans\Cross Sections - Feb 23 2010.dwg

Part of Lots 22 and 23, Conc. 3
 Part of Lots 21 - 24, Conc. 4
 Town of Halton Hills,
 Regional Municipality of Halton

DUFFERIN AGGREGATES
 a Division of Holcim (Canada) Inc.
 2300 Steeles Avenue W., Suite 400

